



HYDRANTS

GUARDIAN DUAL CHECK 1/4 TURN NON-FREEZE WALL HYDRANT WITH AUTOMATIC DRAINING INTEGRAL VACUUM BREAKER AND DUAL CHECK VALVE

EXPOSED HOSE CONNECTION

FUNCTION: For installation in interior or exterior building walls where an exposed hose connection is acceptable. Provides positive non-freeze protection. Adaptable to all types of wall construction.

1/4 Turn of the Key Allows Full Flow to Be Obtained

Meets ANSI A112.21.3M Specifications
Complies w/ ASSE 1019-B, 1052 and 1053.
IAPMO Listed- File #2749
Patent No. US 6,752,167

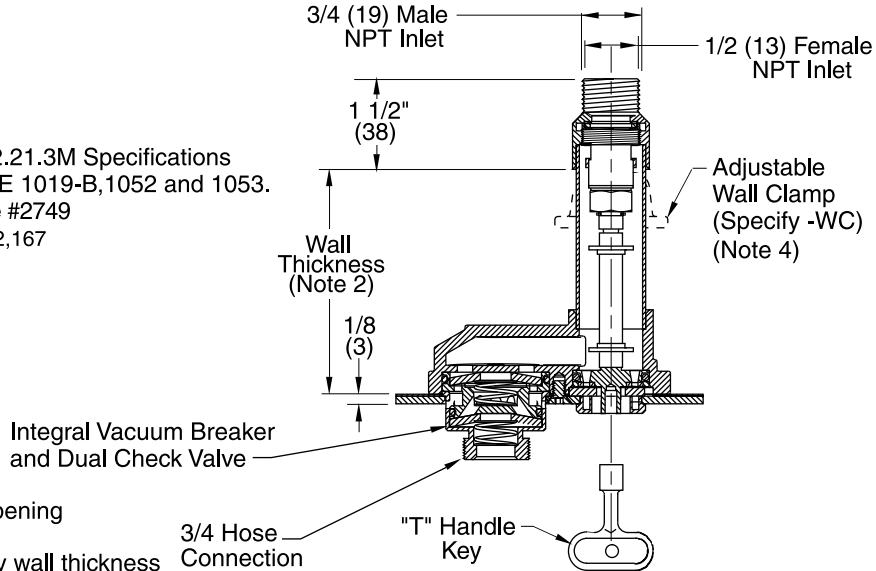

TOP VIEW

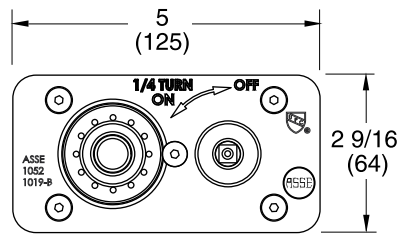

FRONT VIEW

FIG. M-3619

Seepage of a small amount of water may occur from the Vacuum Breaker upon the initial opening and closing of this hydrant. This is normal operation.

NOTES:

1. Recommended wall opening 2 1/4 (57) x 4 (100).
2. When ordering, specify wall thickness in 1 (25) increments as follows 4,5,6,7,8.....24.
3. All hydrants are manufactured with "NO-LEAD" brazing rings, and USDA approved lubricants.
4. When wall clamp -WC is desired, increase wall thickness dimension by 2 (51).
5. Add 3/4 (19) to Overall Length When Specified
6. When specifying Fig. 3619 (-SAP) the wall thickness shall be 2 (51).
7. Dimensions shown in parentheses are in millimeters.
8. The AB1953, California Lead Law, and NSF/ANSI Standard 61-2008 - Drinking Water System Components are not applicable to hydrants as they do not convey/dispense water for human consumption through drinking or cooking.
9. FOR IRRIGATION PURPOSES ONLY.

REGULARLY FURNISHED:

Bronze Quarter Turn Non-Freeze Automatic Draining Hydrant with Stainless Steel Face, Hose Connection, Integral Vacuum Breaker and Dual Check Valve and "T" Handle Key.

VARIATIONS:

- Adjustable Wall Clamp -WC (Note 4)
- 1 (25) Hose Connection -HC1
- 1 (25) Male NPT Inlet Connection -IC1 (Note 5)
- Mild Climate -SAP (Note 6)
- Wheel Handle (-WH)

OPTIONAL MATERIALS:

- Polished Bronze Face -PB
- Chrome Plated Face -CP

Please visit www.murdockmfg.com for most current specifications.



HYDRANTS

Hydrant Part List GUARDIAN DUAL CHECK 1/4 TURN NON-FREEZE WALL HYDRANT

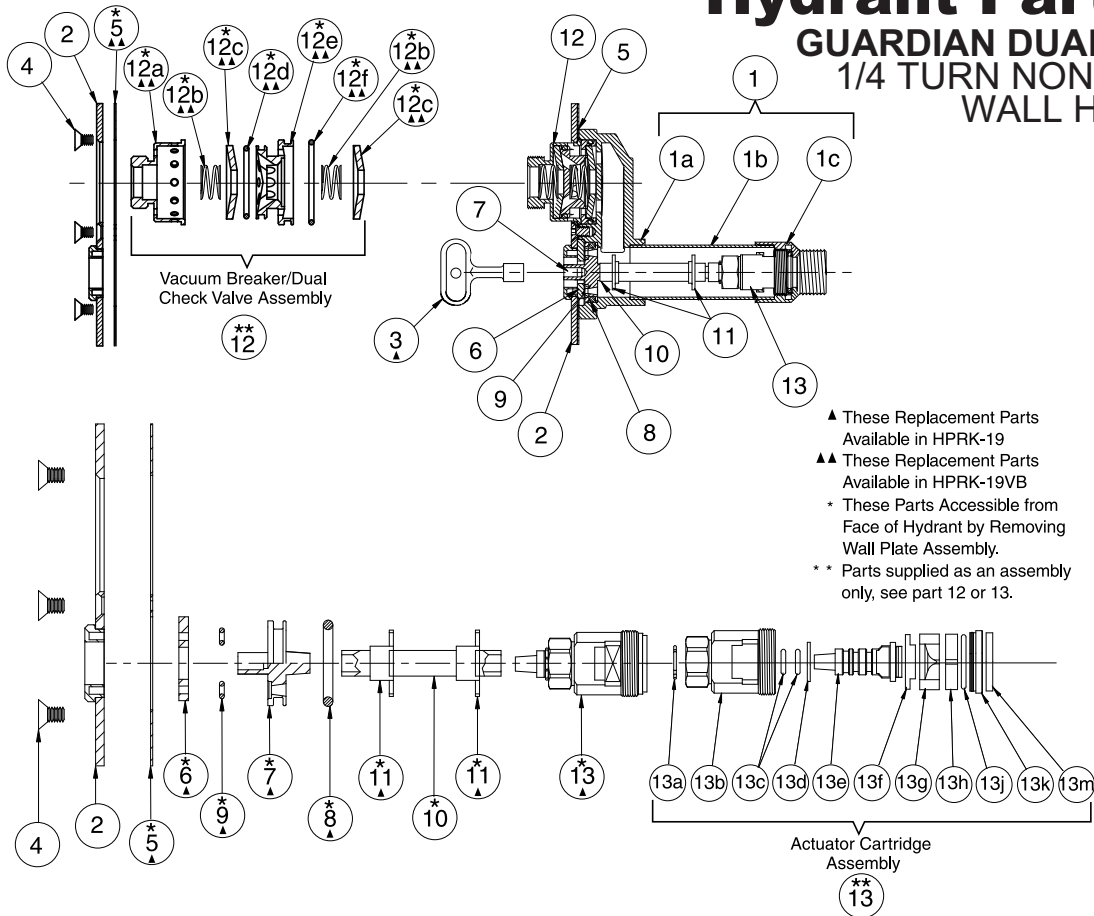

- ▲ These Replacement Parts Available in HPRK-19
- ▲▲ These Replacement Parts Available in HPRK-19VB
- * These Parts Accessible from Face of Hydrant by Removing Wall Plate Assembly.
- ** Parts supplied as an assembly only, see part 12 or 13.

HYDRANT PARTS LIST							
NO.	DESCRIPTION	NO.	DESCRIPTION	NO.	DESCRIPTION	NO.	DESCRIPTION
1	Casing Assembly	7	Moveable Operator Piece	12d	**Small O-Ring	13f	**Nylon Thrust Washer
1a	Head	8	Moveable Operator O-Ring	12e	**Flow Diverter	13g	**Rotating Ceramic Disc
1b	Casing	9	Drain Hole Seal (2)	12f	**Large O-Ring	13h	**Fixed Ceramic Disc
1c	Valve Housing	10	Operator Rod	13	Actuator Cartridge Assembly	13j	**O-Ring
2	Wall Plate Assembly	11	Operator Rod Guides (2)	13a	**Retaining Ring	13k	**O-Ring Gasket Retainer
3	Key	12	Vacuum Breaker/Dual Check Valve Assembly	13b	**Valve Body	13m	**Rubber Seal
4	Wall Plate Securing Screw (5)	12a	**Vacuum Breaker Housing	13c	**Actuator O-Ring (2)		
5	Wall Plate Gasket	12b	**Spring (2)	13d	**Nylon Thrust Spacer		
6	Stationary Operator Piece	12c	**Cone Washer (2)	13e	**Valve Actuator		

ONE YEAR LIMITED WARRANTY - Parts are warranted for one (1) year from date of shipment.

SELECTION SUMMARY & APPROVAL FOR MANUFACTURING	
<p><small>All dimensions are subject to manufactures tolerance of plus or minus 1/2" nominal and subject to change without notice. Murdock Mfg. assumes no responsibility for use of void or superseded data. Dimensions may change with the addition of optional accessories. Murdock Mfg.™, Member of Morris Group International™. Please visit www.Murdockmfg.com for most current specifications.</small></p>	<p>Model Numbers & Options _____ Quantity _____</p> <p>Company _____ Date _____</p> <p>Contact _____ Title _____</p> <p>Approval for Manufacturing/Signature _____</p>