



RESTROOM FIXTURES

Super Secur

MODEL 1035F / 1036F
URINAL, FRONT MOUNTED
HEU HIGH EFFICIENCY URINAL

TECHNICAL DATA

High Efficiency Urinals are engineered to combine attractive looks with versatility, and intended for mounting onto a finished wall from an accessible pipe chase. Unit features a contoured interior to facilitate cleaning. Urinals mounted at 17" rim height comply with ANSI, ADA, UFAS accessibility requirements. Compliance is subject to the interpretation and requirements of the local code authority.

Fixture bowl is fabricated of 16 gage type 304 stainless steel and the housing fabricated of 18 gage type 304 stainless steel with exterior surfaces polished to a satin finish.

Urinal is a high efficiency type requiring a 1/8 GPF (0.47 Liters per Flush) to 1/2 GPF (1.8 Liters per Flush) flush valve and supplied with 3/4" NPT flushing inlet connection and 1-1/2" O.D. plain end P-Trap.



Model Shown: 1036F HEU, TOP SUPPLY WITH OPTIONAL FLUSH VALVE

OPTIONS

(additional costs may be incurred)

- | | |
|----------------------------------|--|
| <input type="checkbox"/> - 1035F | Front Mount Urinal, HEU, Wall Supply |
| <input type="checkbox"/> - 1036F | Front Mount Urinal HEU, Top Supply |
| <input type="checkbox"/> - FVBO | Flush Valve by Others |
| <input type="checkbox"/> | Flush Valve, Lever Handle |
| | <input type="checkbox"/> 0.125 GPF <input type="checkbox"/> 0.50 GPF |

SUGGESTED SPECIFICATIONS

Provide Murdock Super Secur Stainless Steel Urinal (specify model number and options). Urinal mounted at 17" rim height to comply with ANSI, ADA and UFAS accessibility requirements. Interior to have a contoured surface to facilitate cleaning. Fixture shall be fabricated of 18 gage with 16 gage bowl type 304 stainless steel with exposed surfaces polished to a satin finish

Please visit www.murdockmfg.com for most current specifications.



Member of
U.S. Green
Building
Council



Recyclable
Product



Complies
with the
following
standards:



MURDOCK MFG. • 15125 Proctor Avenue • City of Industry, CA 91746 USA
Phone 800-453-7465 or 626-333-2543 • Fax 626-855-4860 • www.murdockmfg.com

Member of
MORRIS GROUP
INTERNATIONAL



RESTROOM FIXTURES

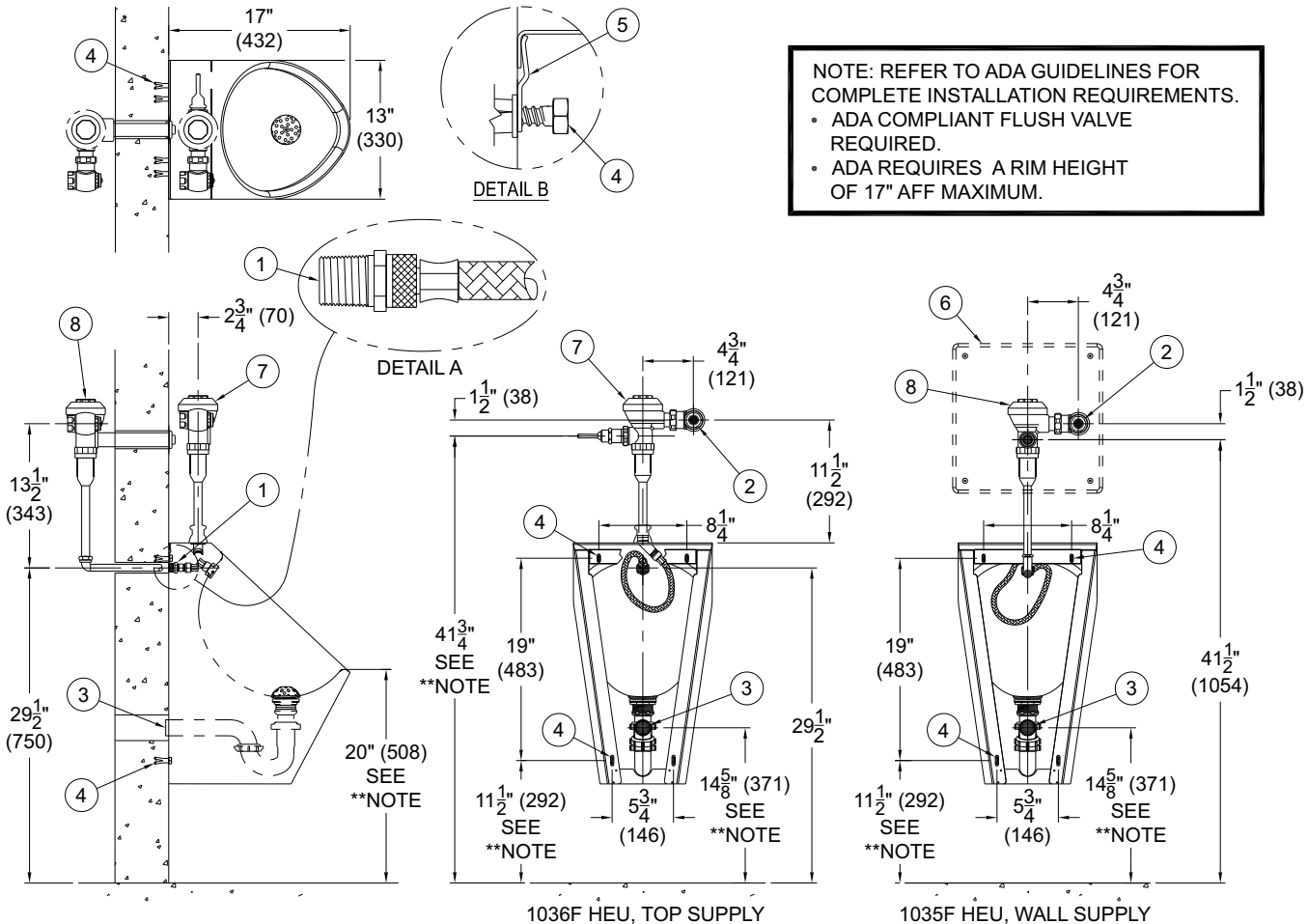

NOTE: REFER TO ADA GUIDELINES FOR COMPLETE INSTALLATION REQUIREMENTS.

- ADA COMPLIANT FLUSH VALVE REQUIRED.
- ADA REQUIRES A RIM HEIGHT OF 17" AFF MAXIMUM.

- | | | |
|---|---|--|
| <p>1. MALE ADAPTER WITH FLEXIBLE HOSE PROVIDED FOR 1035F WALL SUPPLY MODELS, DETAIL "A"</p> <p>2. 3/4" NPT FLUSH VALVE INLET</p> <p>3. 1-1/2" OD PLAIN END WASTE OUTLET</p> | <p>4. Ø 5/16" x 1" LONG ANCHORING SLOTS FOR ANCHORING HARDWARE BY OTHERS</p> <p>5. MOUNTING S-CLIP</p> <p>6. OPTIONAL 2898 FLUSH VALVE ACCESS PANEL SHOWN</p> | <p>7. TOP SUPPLY OR EXPOSED FLUSH VALVE</p> <p>8. WALL SUPPLY OR CONCEALED FLUSH VALVE</p> |
|---|---|--|

Murdock Mfg.™ warrants that its products are free from defects in material or workmanship under normal use and service for a period of one year from date of shipment. Murdock's liability under this warranty shall be discharged solely by replacement or repair of defective material, provided Murdock™ is notified in writing within one year from date of shipment, F.O.B. Industry, California.

SELECTION SUMMARY & APPROVAL FOR MANUFACTURING	Model Number & Options _____	Quantity _____
	Company _____	
	Contact _____	Title _____
	Signature (Approval for Manufacturing) _____	Date _____
	<p>All dimensions are subject to manufactures tolerance of plus or minus 1/2" nominal and subject to change without notice. Murdock assumes no responsibility for use of void or superseded data. Dimensions may change with the addition of optional accessories. Murdock Mfg.™, Member of Morris Group International™. Please visit www.murdockmfg.com for most current specifications.</p>	

MURDOCK MFG. • 15125 Proctor Avenue • City of Industry, CA 91746 USA
 Phone 800-453-7465 or 626-333-2543 • Fax 626-855-4860 • www.murdockmfg.com

